



Vertical Markerboard Mounting Instructions

Vertical Markerboard Mounting Instructions

WARNING: Use caution when handling panels. Do not stand panels on spline edge. Splined edges are fragile and will damage easily if not protected.

All vertical panel systems have been pre-assembled and inspected for "fit and finish" by qualified personnel. It is critical that the wall mounted brackets be installed with care and precision to ensure satisfactory results.

Note: Panels are matched in sequence and should be marked with "run" numbers. Identify each panel and install to sequence.

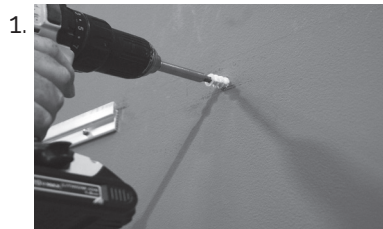

Once the panels are unpacked and identified, determined the layout (spacing) of the mounting brackets and desired position on wall.



Determine anchor locations (always locate & use wall studs whenever possible) and predrill wall mounted bracket accordingly.

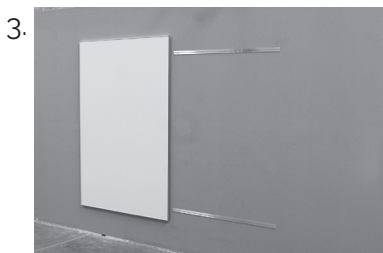

Once hanging brackets are positioned and securely mounted to wall, begin hanging the panels.

Note: Depending on size of panels, additional center brackets (not shown) maybe required



Install steel spline in first panel.



Hang next panel in the sequence and carefully push the two panels together by lifting slightly on the sliding panel and pushing towards the stationary one. Be sure to align steel spline with slot in adjacent panel. DO NOT "force" the panels together. If the spline is properly aligned with the slot they should easily slip together until the gap is closed. If the gap will not close so the two edges are touching, check to make sure that the slot/spline is clear and free of debris and engaging properly. Use caution when sliding the panels together, excess rubbing and bumping of the edges together will damage the porcelain.

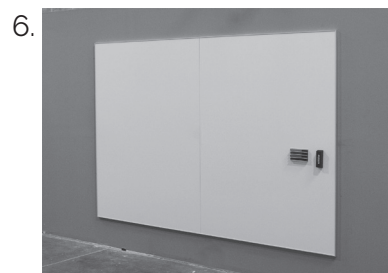

Repeat steps 4 & 5 until all panels are in place

Vertical Markerboard Mounting Instructions

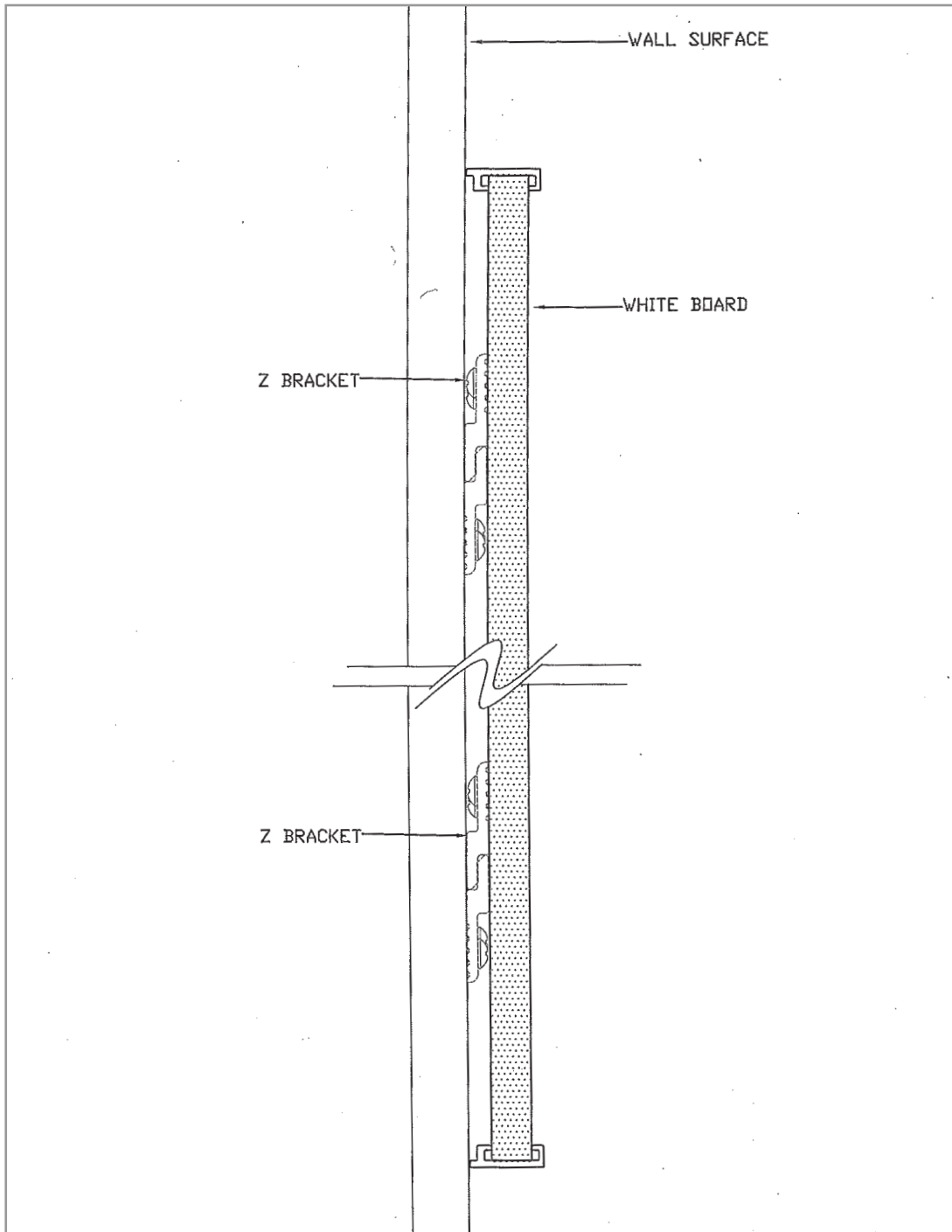

Vertical Markerboard Mounting Instructions

Notes on Installation:

1. ALWAYS anchor the wall mounted brackets into the structural framing (studs) whenever possible. DO NOT exceed recommended spacing between wall anchors.
2. The wall mounted brackets MUST be installed level and parallel to each other with accurate spacing to ensure a safe and proper installation. Always verify spacing by measuring distance between the brackets mounted to the back the Markerboard.
3. If the wall is not "flat" shims may be required between the wall mounted bracket and wall surface.
4. Place the rubber bumpers provided, equally spaced, between the brackets as shown to eliminate movement or "bounce" when using the writing surface.

Installation Note-IMPORTANT!!

For Direct Adhesive Mount- contact coronaVISUAL for more information.
Do Not mount until you get specific instructions from coronaVISUAL.

WARNING: Danger if improperly installed. Installation must be done by a qualified professional. Check the suitability of the wall and ceiling, and make sure that the fastening devices will withstand the loads.

For disposal, the components should be divided by type of material if possible. In any case, this product can be recycled at a community recycling center.